

VAPROFLASHING™ Water Resistive Barrier

NAIL FLANGE WINDOW (USING WALLSHIELD OR WRAPSHIELD)

MATERIALS

- VaproFlashing
- VaproFlashing Factory Formed Corners
- VaproBatten
- VaproTape Single-Sided

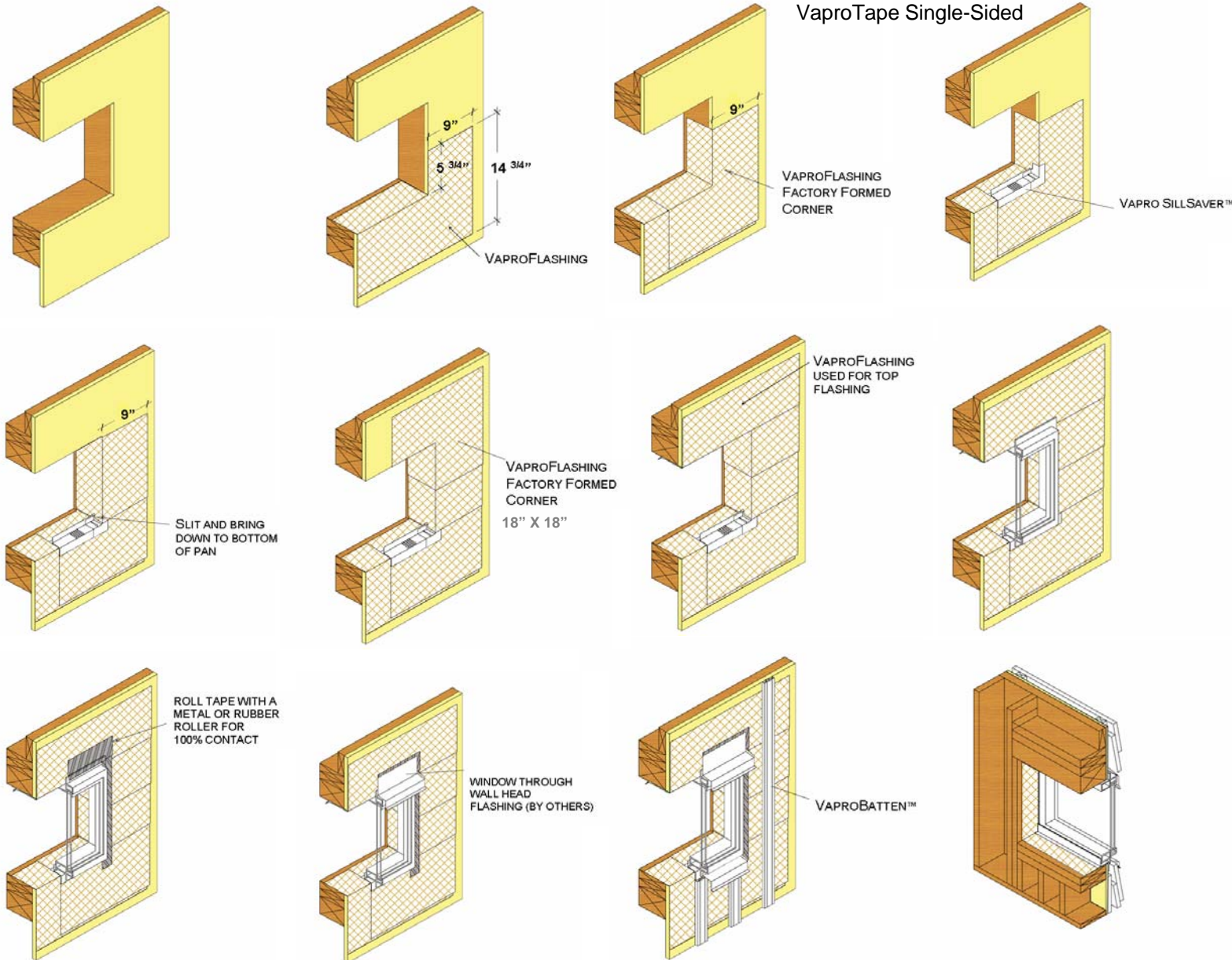

For air barrier system please contact VaproShield at (866) 731-7663 or www.vaproshield.com

VAPROTAPE™ Guidelines (not "AB" Tape)

1. Keep roll at room temperature (68° F +) before use.
2. Apply to a clean dry surface only. If surface has moisture or frost, dry prior to application. If surface is below 50° F:
 1. Heat the surface with a hot air gun and/or
 2. Heat the tape to a warmer temperature (comfortable to the touch) and/or
 3. Wait for the surface to warm up naturally
3. Peel off approximately 4" of release liner (protective film).
4. Apply to surface, covering the seam.
5. Roll with metal or rubber roller for full adhesive contact.

VAPROSHIELD Open Joint Rain Screen Systems

RAIN SCREEN DESIGN

A multiple-element approach to control water penetration into exterior walls

1. First line of defense manages the driving forces of weather
2. Second line of defense designed to intercept all water passing through first line of defense and allowing it to drain to the exterior

VAPROSHIELD BEST PRACTICES

1. Ensure minimum 1/2" batten depth (cavity plus cladding thickness) in rain screen system. Cladding must have a batten between it and water resistive barrier/air barrier
2. At open joint, cover exposed VaproBatten with VaproTape UV Black (see Image C)
3. Include through-wall metal flashing at each floor level in walls exceeding two stories

WallShield

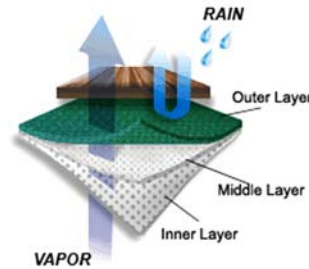

WrapShield

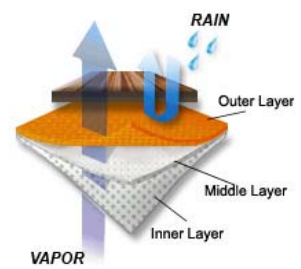

A WallShield (green) with WrapShield (black)

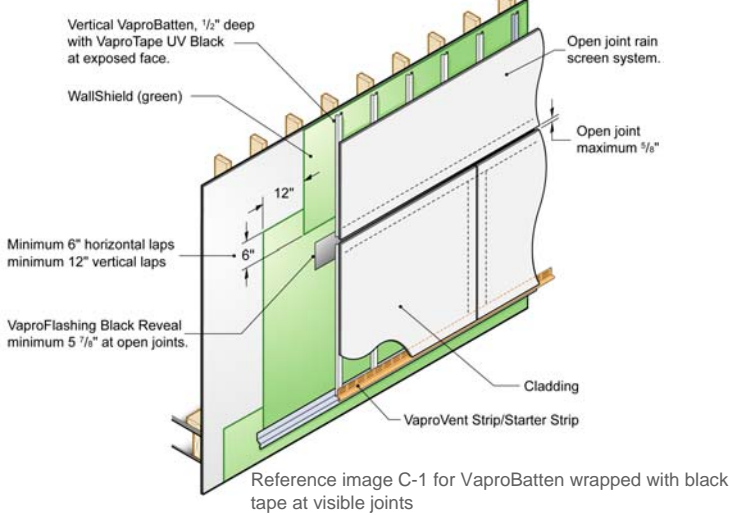

B AIR BARRIER APPLICATION using WRAPSHIELD (orange) and VAPROTAPE AB (Air Barrier) and VAPROFLASHING BLACK REVEAL and VAPROTAPE UV BLACK

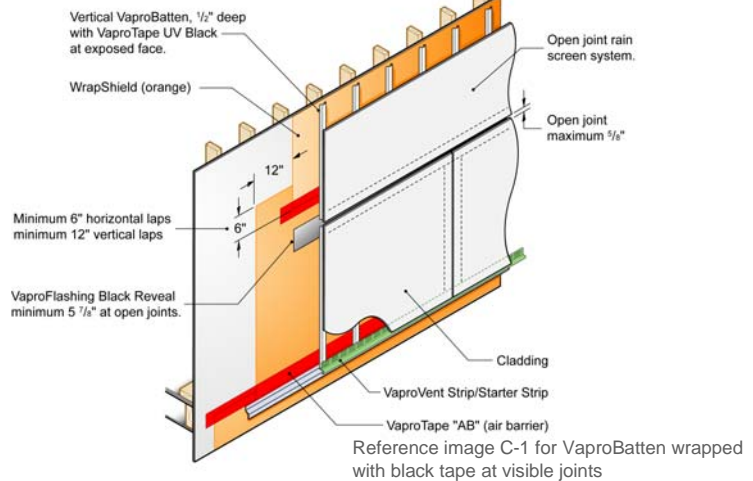

C BLACK WRAPSHIELD LAPPED DOUBLE FOR SMALL PANEL JOINT DESIGN

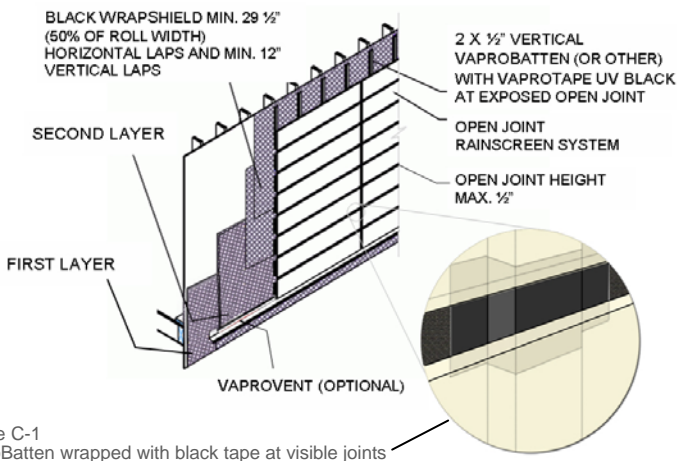

D BEVELED SIDING SYSTEM WITH ONE LAYER OF WRAPSHIELD (ORANGE) OR WALLSHIELD (GREEN)

